



**family**  
moveart playsculptures®





### Playsculpture family

The «family» offers space for a whole family, and is designed to allow movement and relaxation in the same space. The integrated wooden slides provide smaller children with a great opportunity to move and play in the immediate vicinity of the parents, who can relax – either sitting or lying – on the bench. For children from 1 years

### Design:

All objects originate from a single form – the so-called double helix, the form of the DNA strands of all living things. They thus have an energising and harmonising effect on people and the environment.

### Material:

All products are constructed using 100% ecological and sustainable Accoya wood, and have a minimum outdoor life span of 25 years. They are low-maintenance and resistant to vandalism.

### Safety:

All objects are manufactured according to European safety standards for playground equipment SN EN 1176.

### Tech. Specifications:

Length: 300 cm  
 Width: 139 cm  
 Height: 93 cm  
 Weight: 200 kg  
 Critical fall height: 93 cm  
 Freestanding available  
 Number of foundations: 3  
 Construction time (approx.):  
 2 pers. à 2 hrs.



# THE HUMAN IGNITION PROFILE (HIP)

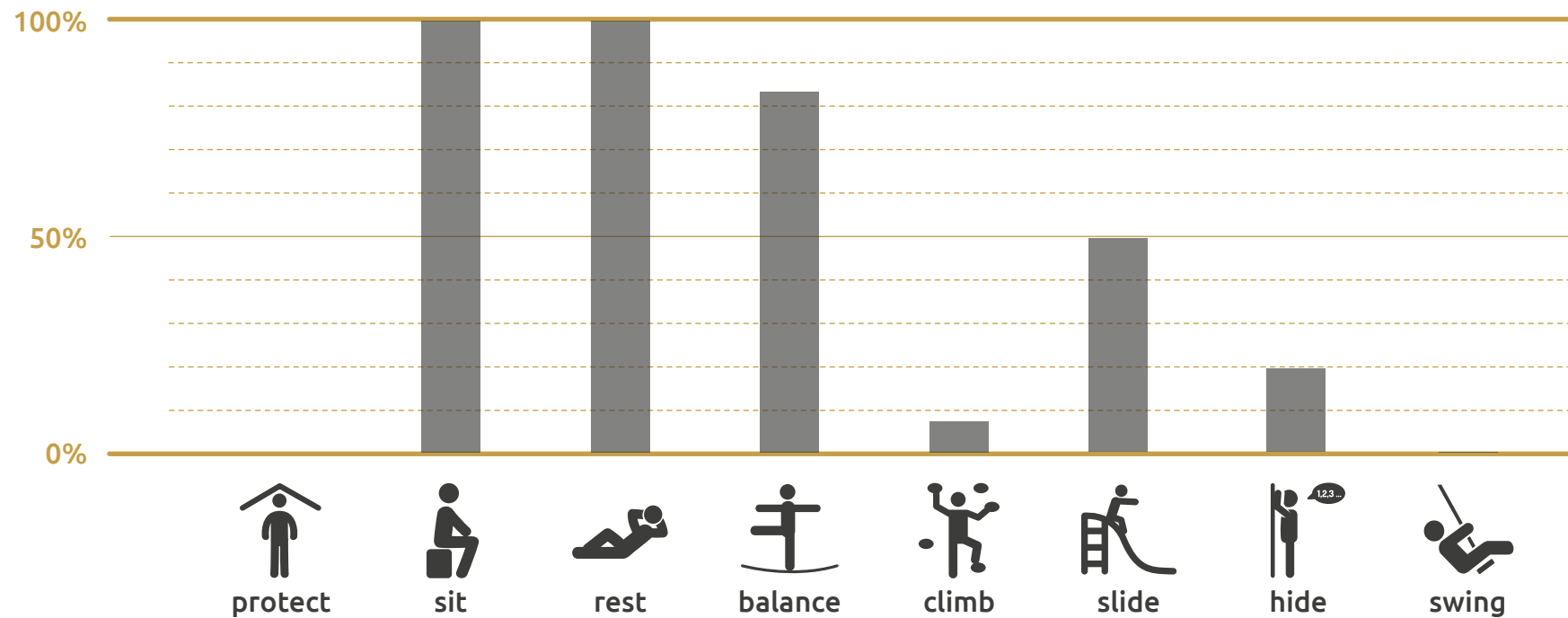

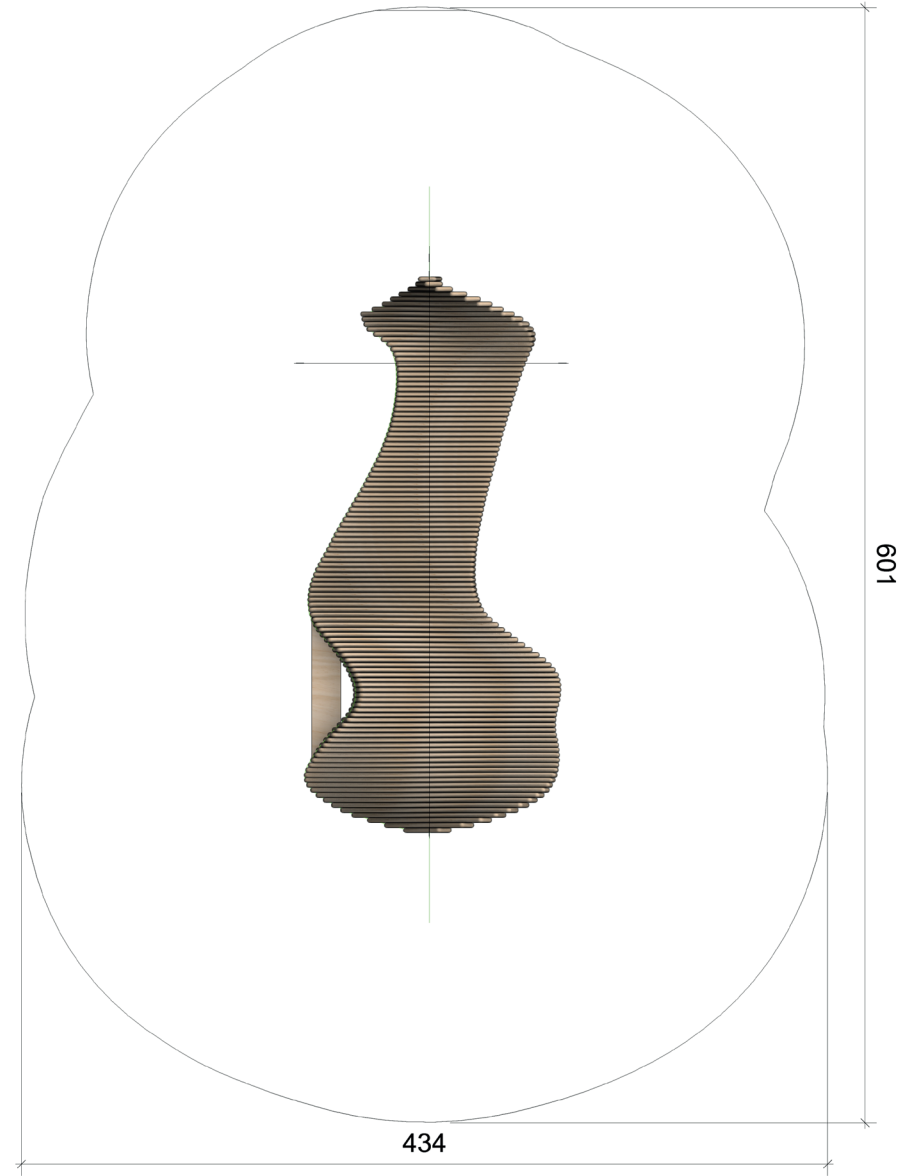
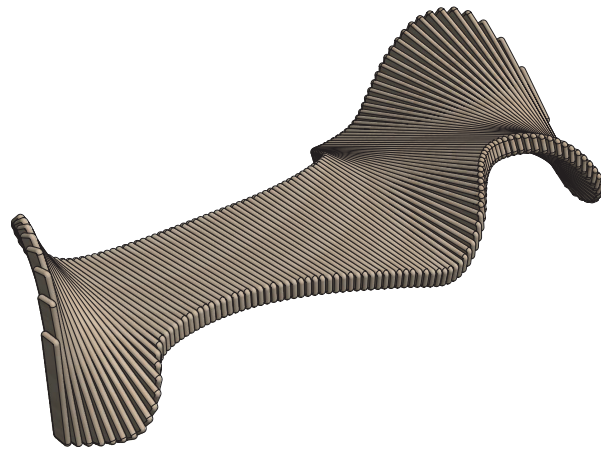
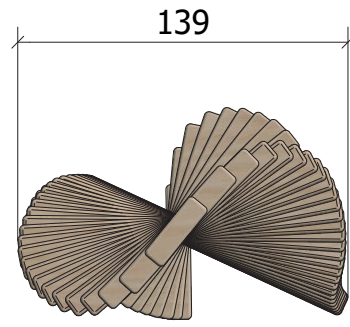
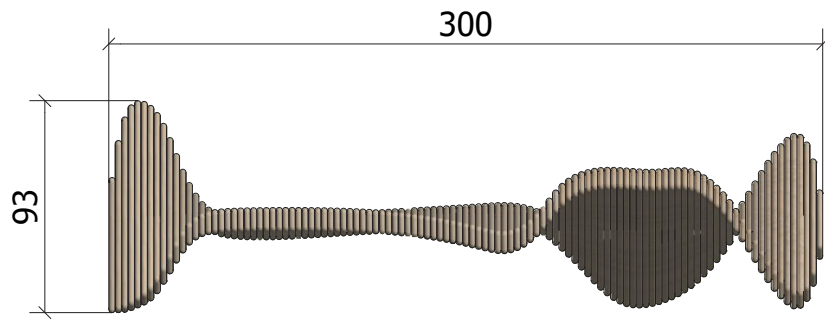

# move art

moveART GmbH

Zürcherstrasse 8  
CH-4143 Dornach

T +41 76 792 95 46

info@moveart.swiss  
www.moveart.swiss